

Alfred Nobel Hall

The spacious Alfred Nobel Hall can be used for exhibitions, receptions, seminars and meetings. It boasts state-of-the-art audio and visual equipment, and its excellent acoustics make it a choice space for concerts. A removable stage is available and comes in different sizes and configurations. The hall can be subdivided into two separate spaces, which can be used either individually or together.

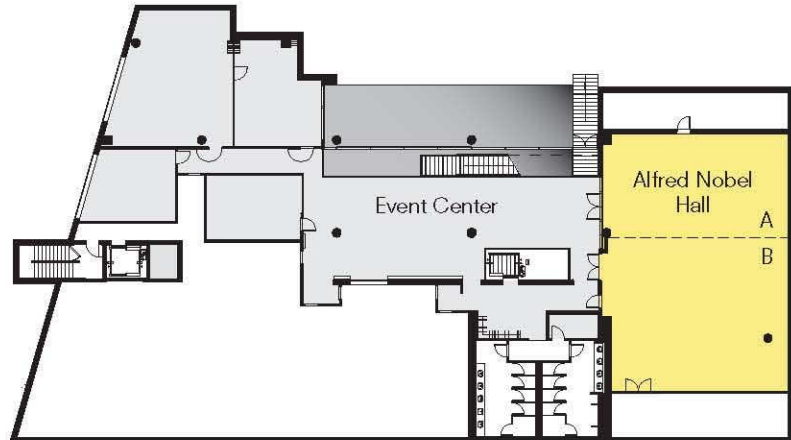

Meeting capacities

Room	Dimensions (ft.)	Size		Ht. (ft.)	Capacities				
		(sq.ft.)	(sq.m.)		Banquet	Theater	Conference	Reception	Classroom
Alfred Nobel Hall	44x61	2670	248	9'-0"	180 pers	180 pers	140 pers	180 pers	120 pers
A	44x24	1050	102	9'-0"	60	80	60	80	50 pers
B	44x37	1620	146	9'-0"	100	120	80	120	70 pers

Theater seating
- See opposite page for alternative layouts

